

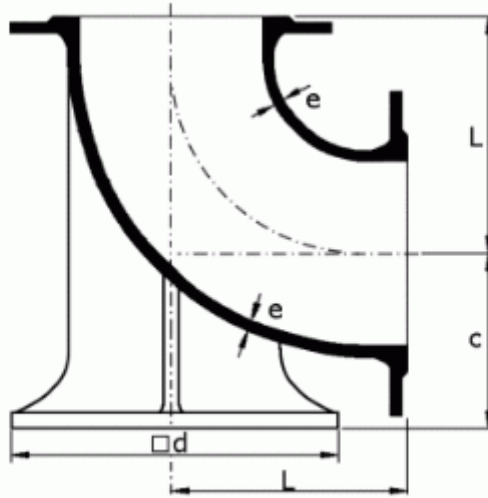

Double Flanged 90° Duckfoot Bend



K=12

Unit: mm

DN	e	L	c	d	Weight (kg)			
					PN 10	PN 16	PN 25	PN 40
80	7.0	165	110	180	14.0	14.0	14.0	14.2
100	7.2	180	125	200	17.3	17.7	18.8	18.8
150	7.8	220	160	250	30.0	30.0	32.0	36.5
200	8.4	260	190	300	46.5	46.0	50.5	61.0
250	9.0	350	225	350	75.0	75.0	82.0	102.0
300	9.6	400	255	400	106.0	105.0	116.0	146.0
350	10.2	450	290	450	139.0	145.0	162.0	-
400	10.8	500	320	500	178.0	189.0	212.0	-
450	11.4	550	355	550	228.8	246.0	277.0	-
500	12.0	600	385	600	283.0	313.0	337.0	-
600	13.2	700	450	700	428.0	481.0	509.0	-
700	14.4	800	515	800	555.8	586.0	-	-
800	15.6	900	580	900	759.6	798.0	-	-
900	16.8	1000	645	1000	1002.2	1050.0	-	-
1000	18.0	1100	710	1100	1297.0	1380.0	-	-
1100	19.2	1200	775	1200	1584.0	1656.0	-	-
1200	20.4	1300	840	1300	1934.4	2063.0	-	-